

SPA9.0 SKIN SPA SYSTEM

VER:2.0

USER MANUAL



Warning

Dear user:

Thanks for using our company's products, in order to fully make use of the products, we sincerely suggests follow:

- ◆◆ Please read the instruction in detail and keep it well for further reading and consulting.
- ◆◆ Please follow the instruction to fit and operate the machine correctly.
- ◆◆ Please do not remove and change any accessories of the machine.
- ◆◆ It forbids others to open and remove the mainframe except the authorized people in the company.
- ◆◆ It forbids others to change and maintain the machine except the professional people.
- ◆◆ Please contact us if there is any trouble during operation.

This product does not belong to medical, please don't use for disease treatment!

Parts Introduction

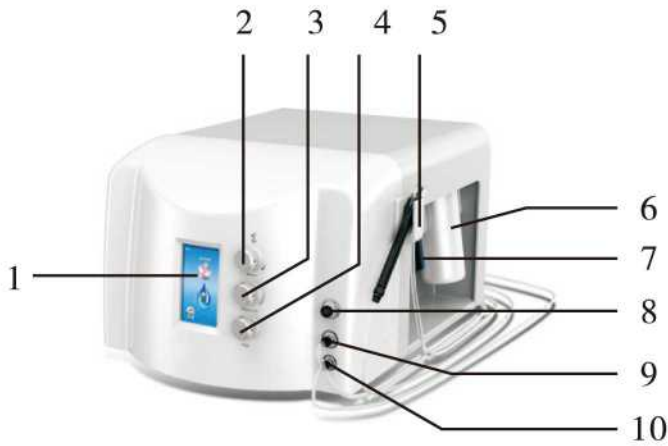

- 1.LCD display screen
- 2.Function selecting knob & Confirming button
- 3.Pressure adjusting knob
- 4.Flux adjusting knob
- 5.Accessory frame
- 6.Wastewater recycling bottle
- 7.Liquid Products bottle
- 8.Diamond dermabrasion handle self-locked jack
- 9.Tube 1 of SPA dermabrasion handle self-locked jack
- 10.Tube 2 of SPA dermabrasion handle self-locked jack
- 11.Filter cup of SPA dermabrasion
- 12Filter cup of Diamond dermabrasion
- 13.Power supply line socket
- 14.Power switch

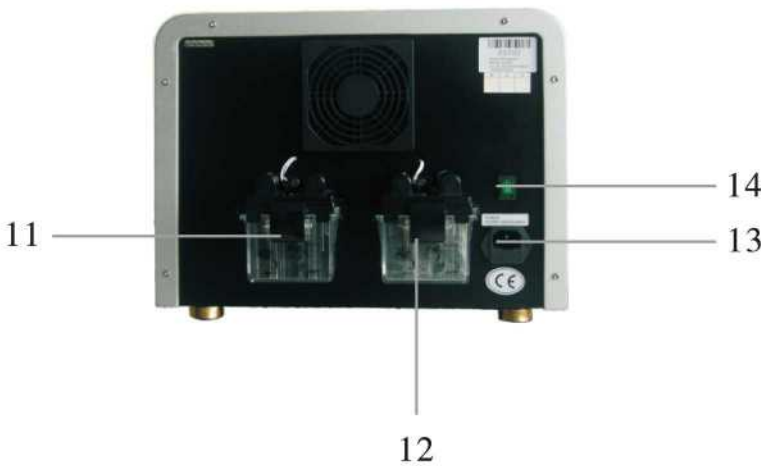

Accessories



SPA dermabrasion handle



Crystal dermabrasion cap



Diamond dermabrasion handle



Diamond dermabrasion head



Diamond SPA dermabrasion head

SPA dermabrasion head

Any part of instrument made of PMMA material (for example: accessories shelf, panel, transparent handles, etc.). Do not use alcohol or corrosive solvent to wipe clean.

Basal Operation

1.Put accessories well and connect them to the host.

(1)Insert the transparent tube of Diamond dermabrasion handle into [8] jack.

(2)Insert the transparent tube 1 of SPA dermabrasion handle into [9] jack.

(3)Insert the transparent tube 2 of SPA dermabrasion handle into [10] jack.

2.Insert the plug of Power supply line into [13] socket, turn on Power switch [14], the system enter into in standby states as (Fig 1).



(Fig 1)

3.In the interface as (Fig 1) shows:

(1)Turn [2] Function selecting knob, when the cursor “ ✓ ” move to “Diamond sculp” means that selected “Diamond dermabrasion” function. Press [2] confirming button to enter interface as (Fig 2).

(2)Turn [2] Function selecting knob, when the cursor “ ✓ ” move to “SPA” means that selected “SPA dermabrasion” function. Press [2] confirming button to enter interface as (Fig 3).

(3)Turn [2] Function selecting knob, when the cursor “ ✓ ” move to “SETTING” , then press [2] confirming button to enter “setting interface” . “Basic setting” choose output language. When the cursor move to “ 🌐 ” , return to interface as (Fig 1).

NOTICE: “Advanced setting” is only for manufacturer, Users do not use.

Diamond Dermabrasion

Operating steps

1. Clean skin and make it dry.
2. In interface as (Fig 2) shows, turn [2] Function selecting knob, when the cursor “👉” move to “Time” to set work time. The system default is 30minutes, press [2] confirming button, When the cursor “V” background change to red, then turn [2] Function selecting knob to adjust, the range is 1 to 120 minutes.
3. According treated parts to choose appropriate diamond dermabrasion head, beauticians connect the diamond dermabrasion head with diamond dermabrasion handle, turn [2] Function selecting knob to “Start” , press [2] confirming button, the system begin working. if you want to pause during operation, press it again.
4. Turn [3] Pressure adjusting knob to adjust dermabrasion pressure intensity, the pressure is strong while turning it to the clockwise, the intensity number is constantly changing. The beautician should consider the nursing part and make sure the guests can accept the pressure.
5. Confine the treatment area, and beautician hold the diamond dermabrasion handle to move closely on skin back and forth, with the finger moves with it.
6. The system will pause automatically if the setting time is over. press any key to continue.
7. When the cursor move to “👉”, return to interface as (Fig 1).

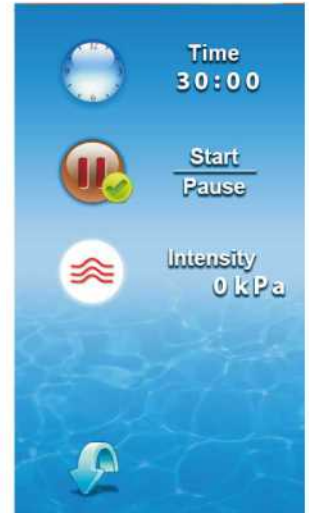

(Fig 2)

Cautions

1. Do not use when there is sensitive skin, swelling, injury, inflammation.
2. Keep your skin in a good condition after treatment, use care products which are gentle and no harm, pay more attention to sun block.
3. Do not do shaving or use scrub until three days later.
4. Another diamond dermabrasion care must be in 30 minutes later.

SPA Dermabrasion

Operating steps

1. Clean skin deeply.
2. Put the liquid products into the liquid bottle.
3. In interface as (Fig 2) shows, turn [2] Function selecting knob, when the cursor “👉” move to “Time” to set work time. The system default is 30minutes, press [2] confirming button, When the cursor “V” background change to red, then turn [2] Function selecting knob to adjust, the range is 1 to 120 minutes.
4. According treated parts to choose appropriate Diamond SPA dermabrasion head or SPA dermabrasion head, then choose appropriate crystal dermabrasion cap. Beauticians connect them with SPA dermabrasion handle,
5. Turn [2] Function selecting knob to “Start” , press [2] confirming button, the system begin working. if you want to pause during operation, press it again.
6. Adjust dermabrasion pressure intensity. Press the Crystal dermabrasion cap with your finger before adjust, and then turn [3] Pressure adjusting knob the pressure is strong while turning it to the clockwise, the intensity number is constantly changing. The beautician should consider the nursing part and make sure the guests can accept the pressure.
7. Turn [4] Flux adjusting knob to adjust dermabrasion flux, the flux is big while turning it to the counter clockwise, the intensity number is constantly changing.
8. Beautician hold the SPA dermabrasion handle on skin for a while until the water flow into the crystal dermabrasion cap, and then drop some water on skin by points, to make the skin surface wet, and then apply cleansing product on the skin, and move the it on skin back and forth.
9. The system will pause automatically if the setting time is over. press any key to continue.
10. When the cursor move to “🌐”, return to interface as (Fig 1).

Cautions

1. Do not use on wound skin.
2. Pour out the water in the waste recycling bottle in time to avoid damage caused by overflowing.
3. Different size of crystal dermabrasion cap can be flush with water directly, then soaked with 75% alcohol.
4. Check [6] Wastewater recycling bottle, [11] Filter cup of SPA dermabrasion and [12] Filter cup of Diamond dermabrasion whether full, if they are full, please clean them immediately.

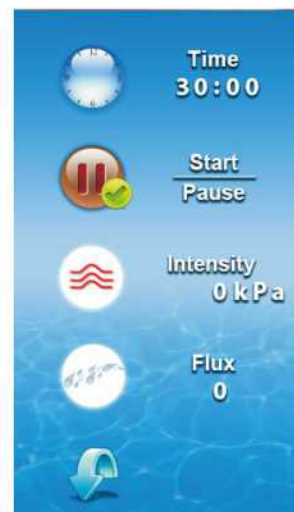

(Fig 3)

Forbidden Group

1. Patients with acute inflammation, asthma, deep vein thrombosis, thyroncus, cancer.
2. People with hemorrhagic disease, trauma or who is bleeding.
3. Patient with skin inflammation or with edema.

Technical Parameters

Input Voltage: AC 220-230V 50/60Hz AC 110V 50/60Hz

Output Power: 150VA

Fuse: FL5X20\2A with buffer (220V machine using) (with spare fuse)

Fuse: FL5X20\3.15A with buffer (110V machine using) (with spare fuse)

Packing List

1. Host	1SET	<input type="checkbox"/>
2. Diamond dermabrasion handle	1PC	<input type="checkbox"/>
3. Diamond dermabrasion head	1BOX(9PCS)	<input type="checkbox"/>
4. SPA dermabrasion handle	1PC	<input type="checkbox"/>
5. Diamond SPA dermabrasion head	1PCS	<input type="checkbox"/>
6. SPA dermabrasion head	1PCS	<input type="checkbox"/>
7. Crystal dermabrasion cap	5PCS(includes a protective cover)	<input type="checkbox"/>
8. Liquid bottle	1PC	<input type="checkbox"/>
9. Waste water recycling bottle	1PC	<input type="checkbox"/>
10. Power supply line	1PC	<input type="checkbox"/>
11. User manual	1COPY	<input type="checkbox"/>
12. Searing ring	2PCS(15*1.5 black)	<input type="checkbox"/>

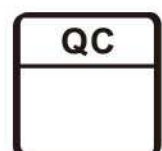

Maintenance

1. Appliances and medical equipment close to the machine may be resulting in operational failure due to interference.
2. Prohibit use of the equipment in the following environment
 - Hot and humid environment
 - Dusty environment
 - Environmental with much smoke or steam
3. If there comes a failure, please shut down the power immediately, and send it to the distributor or manufacturer for maintenance. Do not repair by yourself.

4. Exclusion of liability.

The Company is not responsible for the following circumstances:

- (1) If fire, earthquake, war occurred;
- (2) The fault of the user, operator error;
- (3) Damage caused by using other method (not included in the use manual).
- (4) Operate without the manual's guide.
5. After using the machine for over 40 hours, please take off the dust filter and clean it (If have).
6. Do not make the machine close to the wall, keeping a 30CM space around for cooling.

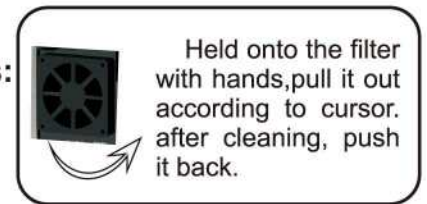

Safety and Environmental Considerations

Toxic and hazardous substances reference list

Electronic information product pollution control and management measures Table of contents of toxic and hazardous substances or elements

Part Name	Toxic and Hazardous Substance or Element						Remark
	Lead (Pb)	Mercury (Hg)	Cadmium (Cd)	Hexavalent chromium (Cr(VI))	Polybrominated biphenyls (PBB)	Polybrominated diphenyl ethers (PBDE)	
Plastic Board	○	○	○	○	○	○	
Printed Circuit Board	×	○	○	○	○	○	
Power Supply	×	○	○	○	○	○	
Accessory	×	○	○	○	○	○	

Declaration:

- The content of the restricted substances in all homogeneous materials of this part is below the limits set by the SJ/T11363-2006 standard.
 - ×
- The content of a homogeneous material in the part of the material is beyond the SJ/T11363-2006 standard requirements. The user's normal use of this product within the time limit of environmental protection, these substances or elements will not occur leakage or sudden change, will not cause the personal, property damage. For such substances or elements, the user shall not dispose of it yourself, please according to government regulations to the relevant departments of the government designated recycling.

Filter cup Remove&Install Method

Filter cup structure

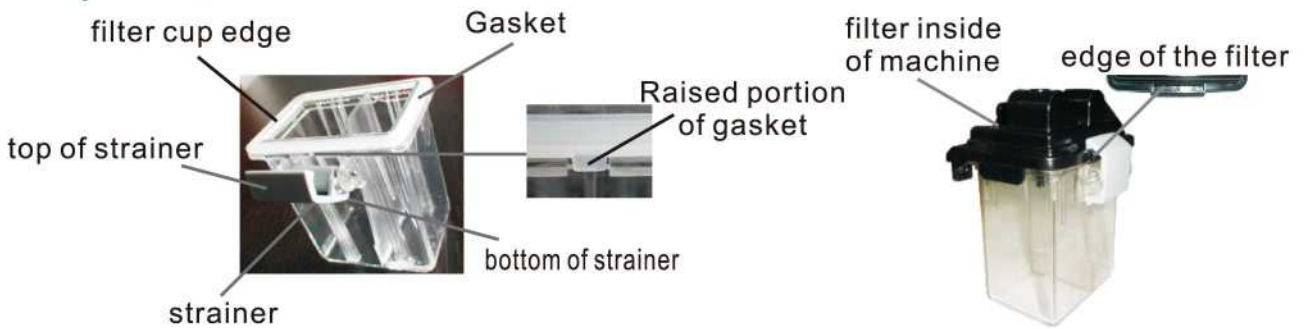

Removing the filter cup operation:

1. Your fingers against the strainer bottom, as (Fig 1) shows.
2. Pull the bottom of strainer, as (Fig 2) shows.
3. And then hike up the strainer, be sure it fully opened, as (Fig 3) shows, take off the filter.



(Fig1)



(Fig2)



(Fig3)

Install filter cup operation:

1. The filter cup slanting inside the host frame, be sure the filter cup edge connect well with filter. as (Fig 4) shows.
2. lift the filter cup to close the filter. as (Fig 5) shows.
3. Make the strainer hold the edge of the filter and press the lower side of the strainer inward. as (Fig 6) shows.
4. Installation finished, check whether connect the filter cup and filter well. as (Fig 7) shows.



(Fig4)



(Fig5)



(Fig6)

Replace the seal ring method:

1. Put the gasket in without raised portion in the slot of the filter cup edge. as (Fig 8) shows.
2. Aim the raised portion at the nick up towards filter cup strainer, put gasket well along the filter cup edge. as (Fig 9) shows.

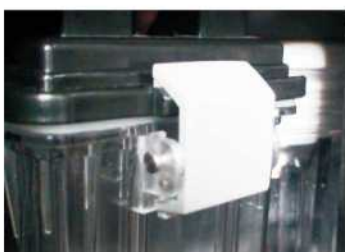

(Fig7)



(Fig8)

Raised portion of gasket



(Fig9)