

# User Manual

Home SPA Instrument

MS-54D1

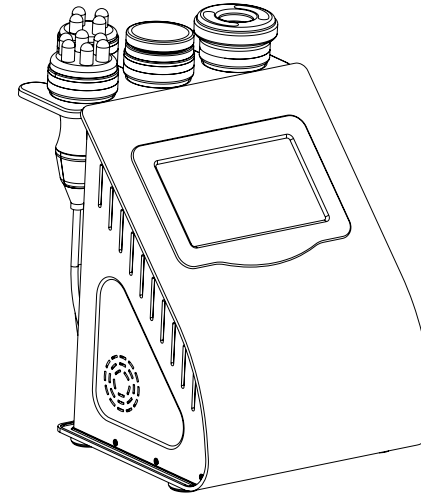

Thank you for purchasing our product.

- Please read this User's Manual carefully for information on how to use the device properly and safely.
- After reading the contents hereof, be sure to keep this User's Manual in an accessible location.
- Make sure to include this User's Manual if you are transferring ownership of the device to another person.

## Contents

### Part I

Safety precautions .....	1
Contraindications .....	2
Overview .....	2
Interface Introduction .....	3
Technical specification .....	5
Precautions .....	6
Maintenance & Cleaning .....	7
FAQ .....	7
Ask & Answer .....	10
Operation guide .....	12
Warranty and support .....	15

## Safety precautions

1. Please read this manual carefully before use and familiarize yourself with the operation of this instrument and related technology.
2. This instrument is a high-precision electronic device that requires proper storage. Please avoid storing it in humid conditions, direct sunlight, or near flammables and explosives to prevent damage.
3. Always use the designated accessory provided or recommended by the manufacturer to ensure performance throughout its service life.
4. Do not place the instrument in high-temperature conditions, as this may negatively impact its service life and performance.
5. Do not apply the instrument on eyes, thyroid, parathyroid, testicles, pregnant women's abdomen, pacemakers, etc.
6. Patients should refrain from using this instrument unless they have obtained permission from their doctor.
7. Ensure to apply the instrument on moist skin and avoid the operation on dry skin.
8. Power off the instrument when not in use to ensure its safety.
9. If you are currently taking weight-loss drugs, please discontinue their use 1 - 2 months before using this instrument. Failure to do so may result in an extended course of treatment.
10. To maintain hygiene and extend the instrument's service life, sterilize it with saline.

## Contraindications

Before using this instrument, it is essential to consult your doctor or seek advice from professionals. Details as below:





1. Pregnant or lactating woman.
2. Individuals with hypertension, heart disease, or a pacemaker.
3. Individuals with unhealed wounds or those in the recovery period from surgery.
4. Individuals suffering from epilepsy, severe diabetes, and hyperthyroidism.
5. Individuals suffering from malignant tumors, hemophilia, and hemorrhage.
6. Individuals with skin disease or infectious disease.
7. Individuals have had a cesarean section within six months, a miscarriage within three months, or a natural birth within two months.
8. For your safety, refrain from using if you've had plastic surgery or have implants/metal objects near the treatment area within 3 months.

## Overview

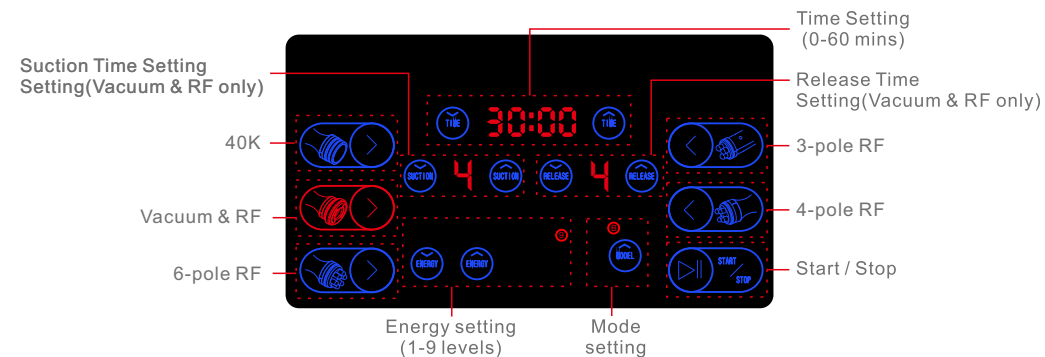
With the most popular and safest technology, this 5-in-1 beauty instrument ensures you achieve your desired body figure. It provides the perfect solution for people seeking improvements in skin appearance and body figure without injections, drugs, or side effects. For external use with immediate effects.

## Interface Introduction



Mode Setting					
A	Continuous working	Infrared light is always on	Infrared light is always on	Infrared light is always on	Infrared light is always on
B	Intermittent working	The infrared light turns on when it touches the skin	The infrared light turns on when it touches the skin	The infrared light turns on when it touches the skin	The infrared light turns on when it touches the skin

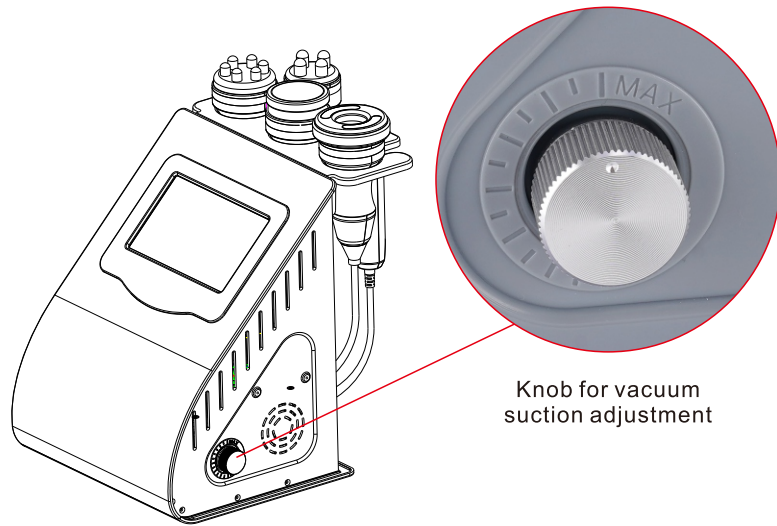

## Technical specification

	Power supply Input: AC110V-240V		Net Weight: 5.0kg	
	Power: 75W		Gross Weight: 6.0kg	
	Dimensions: 10.2x14x14.8inch			
	Input Power: 75W			
	Frequency: 40KHZ		Frequency: 1MHZ	Air flow: 10LPM
	Power: 30W		Power: 75W	Noise level: <60dB (30cm away)
	Frequency: 1MHZ		Frequency: 1MHZ	
	Power: 67W		Power: 60W	Power: 35W

## Precautions

1. Strictly follow the instructions in the manual to use the instrument and train operator.
2. Before using the instrument, you must use a plug with a grounding pin and ensure that the power socket is grounded.
3. Make sure the voltage of the instrument is adapted. If the local power supply voltage is unstable, we advise you to add a power-matched regulated power supply between the mains and the instrument.
4. Remove all the metal objects inside the body to avoid causing accidents or affecting treatment effects.
5. Stop the intake of weight drugs 1 - 2 months before the treatment, or extend the treatment course if you want to take the treatment immediately.
6. Do not use the instrument on an empty abdomen, and take the treatment 1 hour later after the meal.
7. Ensure full skin contact with the treatment head throughout the session to avoid uneven heat distribution.
8. Refrain from using the 40K handle on areas such as the head, chest, breast, heart, or back.
9. Always start with the lowest vacuum intensity.
10. Ensure the filter cotton is installed inside the vacuum handle, as the foreign body may block the handle.

## Maintenance & Cleaning

1. Disconnect the power cord when not in use and store the instrument in a dry, cool, and well-ventilated place.
2. Clean and sanitize the handle's surface with a damp cloth or saline, and then dry it thoroughly with a dry towel to ensure it remains dry.
3. Before cleaning the Vacuum & RF handle, ensure to remove the filter cotton to prevent the growth of bacteria.
4. After cleaning the instrument, cover it with a dustcloth or plastic wrap. Before use, ensure to sanitize the handle again for hygienic reasons.
5. Disassembling the instrument and attempting to clean the inside is strictly prohibited. This task should only be performed by professionals.

## FAQs

### 1. How soon can I expect to see results from RF treatment?

A: You might experience skin tightness right after the treatment, as the heat stimulation tightens the collagen tissue, and the RF stimulates the subcutaneous tissue the brings the continuous regeneration of collagen, leading to more noticeable results within one week.

### 2. Is RF harmful to the skin?

A: RF firming and anti-wrinkle treatment is a non-surgical method that stimulates collagen regeneration and metabolism in the deeper layers of the skin without causing any harm. It's normal to experience temporary heat and redness in the treated area, which indicates increased blood circulation and should fade within a few hours. There's no need to be concerned about this reaction.

### 3. What is the duration of a body sculpting treatment?

A: Approximately 60 minutes, our skilled techniques and advanced instrument guarantee impressive results.

#### 4.Liposuction or our device?

A: Liposuction surgery utilizes negative pressure to remove excess fat from specific areas, resulting in a slimming effect. It provides you with immediate results, but it also carries risks, requires anesthesia, and involves downtime. While our device offers a risk-free solution with no side effects. It sculpts your body, stimulates collagen regeneration for lifted skin, and creates the ideal figure for an overall improved appearance.

#### 5.Is it safe to use ultrasound on the entire body?

A: NO. Ultrasound can break down fat cells, causing the cell walls to rupture and releasing fat, which is then absorbed and metabolized by the lymphatic system. The power of ultrasound is quite strong, and the heart is particularly sensitive to sound waves due to being a hollow organ. Sound waves can cause vibrations in the heart, and there can be variations in how sound waves are conducted through muscle tissue and blood within the heart, resulting in back-and-forth reflections. As a consequence, the valve may become dislodged from the heart muscle. Certainly, ultrasound treatment should be strictly avoided around the eye area to prevent the risk of retinal detachment, as well as areas such as the waist, back, and chest, as well as areas such as the waist, back, and chest.

#### 6.Are there any side effects of ultrasound on the human body?

A: High-frequency sound wave is a non-surgical, non-invasive procedure that does not require incision or anesthesia. How does the ultrasound work: ultrasound (mechanical wave) - cavitation blasting - ultrasound focussing. The effect: fat breaking - fat dissolving - skin tightening and body sculpting, therefore, it only targets the low-density fat tissue and protects the high-density tissue such as blood vessels and nerves, ensuring no adverse effects on the human body. You may notice a slight noise in your ears during the session, which is a normal occurrence and requires no cause for concern.

#### 7.Why do I hear noise in my ears during the treatment?

A: When the ultrasound with concentrated energy vibrates strongly and has a frequency higher than 20Khz, it can penetrate the skin to reach the fat layer that is 20mm deep. The energy causes high-speed friction and heat among the fat cells, which breaks them down and emulsifies them. However, this process can create noise that may be audible in your ears.

#### 8.What is collagen?

A: Collagen is a biological polymer substance, a white opaque fibrous protein without branched chains, which can replenish essential nutrients needed by all layers of the skin and enhance the collagen activity in the skin, with the effects of locking moisture, moisturizing the skin, delaying aging, improving facial laxity and hair care. Collagen is an essential nutrient for promoting anti-aging effects. As you age, the gradual loss of collagen in your skin becomes evident. Typically, a woman's skin starts showing signs of aging around the age of 20 due to collagen depletion, and the rate of loss peaks at 25. Research suggests that by the age of 40, collagen levels are only about half of what they were at 18. The reduction in collagen and moisture content can contribute to the development of facial folds and wrinkles. This is primarily due to the breakdown of collagen fibers and elastic networks that support the skin. This loss also leads to oxidation, atrophy, and collapse of skin tissue, resulting in various signs of aging such as dehydration, wrinkles, looseness, and lack of elasticity.

#### 9.Why is buttocks wellness care important?

A: Because buttocks care can enhance lymphatic drainage, alleviate gynecological issues, and prevent complications arising from blocked buttocks. Traditional Chinese medicine suggests that blocked buttocks often coincide with gynecological issues. Numerous organs are situated within or interconnected with the buttocks region. The pelvic cavity and intestinal tract reside here, while the belt vessel, lumbar spine, and sciatic nerve lie above. To the front are the uterine ovaries and adnexa, and underneath are the anus, vagina, and inguinal lymph. Due to the influence of the Shangjiao and Xiajiao meridians, the buttocks are particularly susceptible to issues related to cold, dampness, and blood stasis. Coldness in the buttocks can lead to contraction of the associated meridians, potentially causing issues such as dysmenorrhea, irregular menstruation, dark menstrual color, blood clots, and poor menstrual blood flow. Additionally, the impact of coldness in the buttocks can extend to affect the process of conception.

## Ask & Answer

Ask	Cause	Answer
Instrument fails to turn on?	The power cord is disconnected to the wall socket.	Check if the power cord is well connected to the wall socket and ensure that the socket is functional.
The instrument has stopped functioning and cannot be restarted?	The fuse is loose or burned.	Replace the fuse located on the back of the instrument and then restart it.
	The fuse may have burned out due to unstable voltage or prolonged operation.	Please replace the fuse and restart the instrument 5 minutes later.
The screen shows an error message.	Data error?	<ol style="list-style-type: none"> <li>1. Turn off the instrument and unplug the power cord, and restart the instrument 1 minutes later.</li> <li>2. If the above method doesn't work, please contact with the dealer for a replacement.</li> </ol>

Problem	Caused Reason	Solution
Why is the handle not generating RF energy?	The handle is not properly connected.	Please confirm if the handle plug is well connected to the main unit.
	Oil on the treatment area could result in insufficient contact between the handle and the body.	Apply some mediums on the treatment area.
	The handle is not contact with the body properly.	Ensure complete contact between the treatment head and the skin.
The 40K handle is not functioning.	You might mistakenly think that the handle is not functioning properly due to its low-noise design.	To check if the handle is functioning, please refer to the 40K handle pretest.
	You may have forgotten to apply the gel or have used a product that is not designed for use with the instrument.	Please use the specific gel designed for the 40K treatment.
	Insufficient massage strength.	Apply more pressure and massage with greater force.

# Operational guidance

Face (  )  
10mins



Eye (  )  
10mins

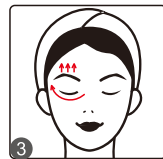
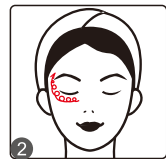

Arm (Step1:  15mins > Step2:  15mins > Step3:  15mins )

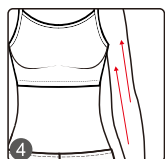
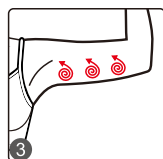
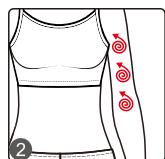

Belly (Step1:  15mins > Step2:  15mins > Step3:  15mins )

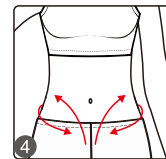
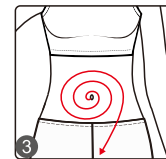
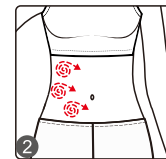
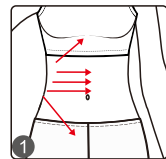

Back (Step1:  15mins > Step2:  15mins )

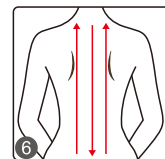
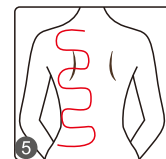
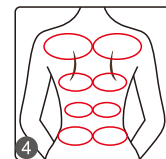
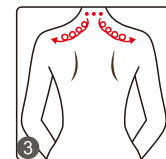
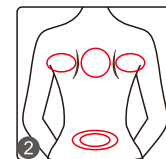
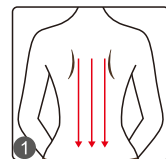



Leg (Step1:  20mins > Step2:  20mins )

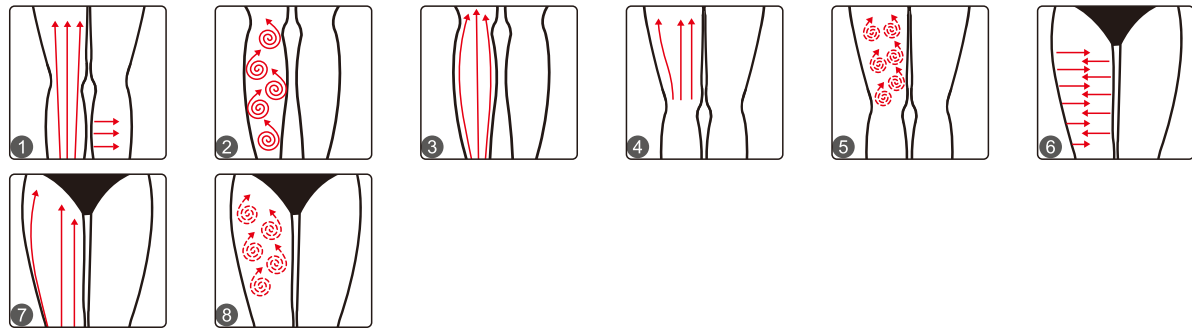

## Warranty and support

We offer a one-year warranty and a three-month period for free returns and replacements from the date of purchase.

Product Name: Versatile Beauty Device  
 Product Model: MS-54D1  
 Production Date: \_\_\_\_\_  
 Quality Inspection: \_\_\_\_\_

