

# ETG80

VER: V1.0

## User manual





---

---

## Warning

Dear user:

Thanks for using our company's products, in order to fully make use of the products, we sincerely suggests follow:

- ◆◆Please read the instruction in detail and keep it well for further reading and consulting.
- ◆◆Please follow the instruction to fit and operate the machine correctly.
- ◆◆Please do not remove and change any accessories of the machine.
- ◆◆It forbids others to open and remove the mainframe except the authorized people in the company.
- ◆◆It forbids others to change and maintain the machine except the professional people.
- ◆◆Please contact us if there is any trouble during operation.

**This product does not belong to medical, please don't use for disease treatment!**

---

---

## Technology Background

Too much fat can damage people's appearance and athletic ability. May also cause various diseases. Too much fatty tissue can be located in various parts of the body, including the thigh, buttocks, abdomen, knee, back, face, arms and other areas. And an excess of adipose tissue may be cause ugly appearance formed by cellular. Excess body fat also related to significant health risk. So we need effective method to control or dissolve excess body fat.

Liposuction is a cosmetic surgery procedure that slims and reshapes specific areas of the body by removing extra fat deposits. Usually operated by the Plastic Surgery or dermatologist with a special surgical instruments for liposuction, it is an invasive way to remove subcutaneous fat tissue.

There are also possible fatal complications and negative side effects associated with having liposuction. These temporary factors include swelling, painful bruising, pain, numbness, limited mobility and allergic reaction. In addition, liposuction is of high cost. There are other new emerging technologies to remove subcutaneous adipose tissue, including Mesotherapy laser-assisted liposuction and high-intensity focused ultrasound.

Other non-invasive way to remove excessive fat including drugs, diet pills, regular exercise, diet control, or a combination of these methods. A disadvantage of these treatments is likely invalid, and even in some cases impossible. For example, when a person physically injured or sick, you can not select the way of regular exercise. Similarly, when the diet pills or external use of drugs are allergic or cause adverse reactions, in addition, the use of physical or systemic approach to lose weight, you can not dissolve the body fat of a selected area.

The Cooling procedure using Cryolipolysis is fundamentally different from other non- or minimally invasive modalities, and it was approved as the most effective way to fat reduction.

This revolutionary new nat loss method, which is approved as an important technology progress in fat reduction since it is put into use. For those people who is on diet, do regular exercise but still remove local fat, Cryolipolysis definitely a great gift. For fat intensive parts and less parts, such as love handles (flanks), and back fat. (loose fat above the hip on both sides of waist), belly and back fat, Cryolipolysis can produce stunning results .

## Cool Technology

As triglyceride in fats will be converted into solid in particular low temperatures. It uses advanced cooling technology to selectively target fat bulges and dissolve fat cells through a gradual process that does not harm the surrounding tissues, reduce unwanted fat, When fat cells are exposed to precise cooling, they trigger a process of natural removal that gradually reduces the thickness of the fat layer. And The fat cells in the treated area are gently dissolved through the body's normal metabolism process, to dissolve unwanted fat.

## Parts Introduction

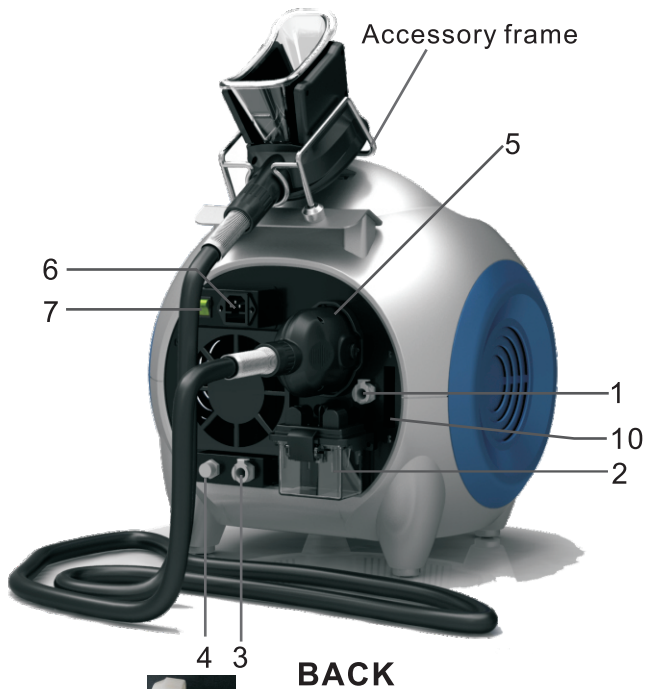

**NOTE:**  
The colloidal particle must be plug back to the hole of valve after cleaning in order to prevent leakage.

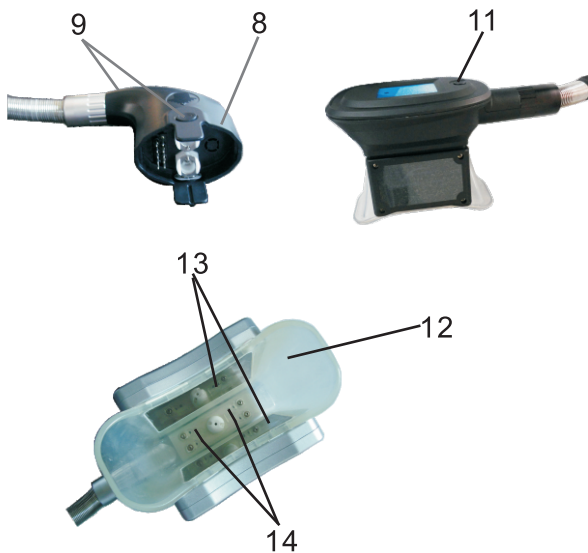

1. Coolant inlet
2. Filter cup
3. Overflow
4. Coolant discharge valve
5. Output connector of Cooling fat dissolving handle
6. Power supply line jack
7. General power switch
8. Plug of cooling fat dissolving handle
9. Buttons of cooling fat dissolving handle
10. Coolant level window
11. Control button of cooling fat dissolving handle
12. Vacuum suction area
13. Freezing area
14. Red/Green LED indicative light



Cooling fat dissolving handle



Fat calipers



Bind ties

Control button of cooling fat dissolving handle:

- △ The first press of the button--to start suction(add pressure)
- △ The second press of the button--to keep the setting suction constantly(stable pressure)
- △ The third press of the button--to pause(no pressure)

---

---

## Before Transportation

1.The coolant should be cleared before transportation.

2.Method:

Open the coolant discharge valve[4] as the picture shows (turning it to the counter clockwise and the pull out the stopper), discharge the coolant, move the machine to help the coolant get out completely.

**Notice:**

**While discharging the coolant, the cooling fat dissolving handle should be placed at the handle support.**

## Steps of Add Coolant

1.Use purified water(or special coolant);

2.Make sure the coolant discharge valve[4] is closed;

3.Use special funnel to connect to coolant inlet[1];

4.Add purified water(or special coolant) from the funnel;

5.Add liquid until the level of the coolant level window[10] arrive at 4.5;

6.Add cooling fluid successfully first time;

7.Connect power supply line[6], turn on general power switch[7].

8.Input password“000000” to enter interface as (Fig 1). Click “Set” to enter interface as (Fig 2) shows and Click “Liquid setting” to enter interface as(Fig 3) shows, click “Start” to become counter down.

9.When stopped, please observe the status of coolant level window, if it doesn't arrive at level 4.5, please add cooling fluid again until the level is above 4.5 ,then take off the funnel.

**NOTE:**

**1.Add about 1L pure water or special cooling fluid, change the water after 3 months.**

**2.When could not add into the coolant, please open the coolant discharge valve, Add the coolant and observe the valve. when the liquid is smooth outflow, blocked it and continue to fill...**

**3.If not using the device 15 days or above, we recommended to put the coolant clean and clear.**

**4.The cooling fat dissolving handle must put on the ground While add coolant .**

## Steps of replace cooling fat dissolving handle

1.Turn off the general power switch first.

2.Please press the buttons of cooling fat dissolving handle [9] and pull it out.

## Basic Operation

1.

- (1) Put the accessories well and connect them to the host.  
Insert the plug of cooling fat dissolving hande [8] to jack [5].
- (2) Insert power supply line to [6], turn on the General power switch [7].
- (3) input default password "000000" to enter interface as (Fig 1) shows.
- (4) Click "set"  to enter interface as (Fig 2) shows.  
Click "→" to enter interface as (Fig 5) shows.

2. In interface as (Fig 2) shows:

- (1) Click "Basic Setting" to select language.
- (2) **NOTE: "Advanced setting" is only for manufacturer. Users do not use.**
- (3) Click "Liquid setting" to enter interface as (Fig 3) shows, the details please refer to "Steps of add coolant".
- (4) Click "Clean gas pipeline" to enter interface as (Fig 4) shows. Click "Start" begin to clean gas pipeline automatically, cleaning time is 3 minutes, please notice the fluid level of filter cup while cleaning, if the filter is full, please click "pause" and cleaning it.

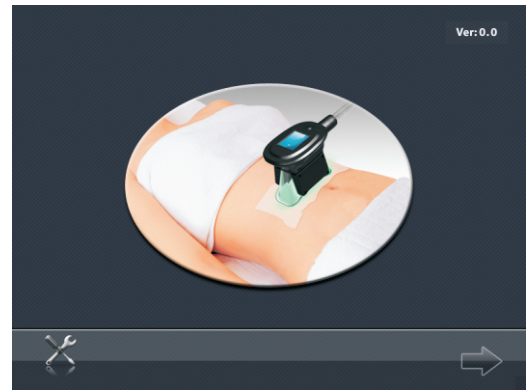

(Fig 1)

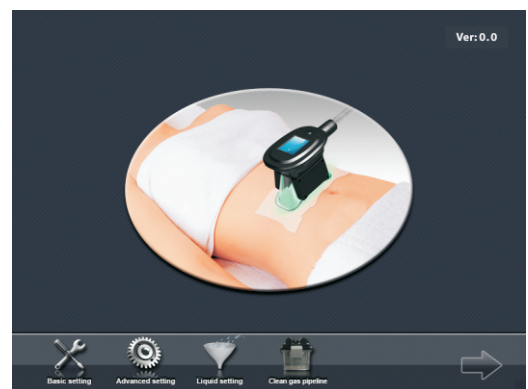

(Fig 2)

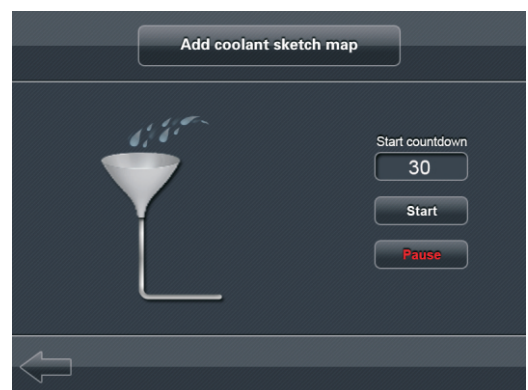

(Fig 3)

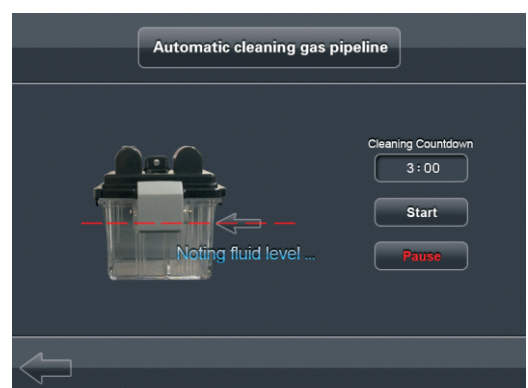

(Fig 4)

## Cryotherapy

1. In interface such as (Fig 1), Click “picture” to enter interface as (Fig 5) “Cryotherapy” function.
2. Click “Cool”, then click “<” and “>” to adjust cool temperature, the system default temperature is  $-5^{\circ}\text{C}$ , the regulating range is  $5^{\circ}\text{C}$ .

**NOTICE: Please operating with the help of professionals when the temperature setting is under  $-5^{\circ}\text{C}$ !**

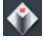
3. Click “” to select vacuum mode: “M” stands for manual mode, “A” stands for automatically mode. Then click “Intensity”, then click “<” and “>” to adjust vacuum intensity, the system default is 60kpa, the range is 10kpa to 80kpa.
4. Click “Time”, then click “<” and “>” to regulate work time, the range is 1 to 120 minutes. The system default is 45 minutes.
5. After setting various parameters, Click pre-start button “||” to enter interface shown as (Fig6). Click “←” to return interface as (Fig 1).

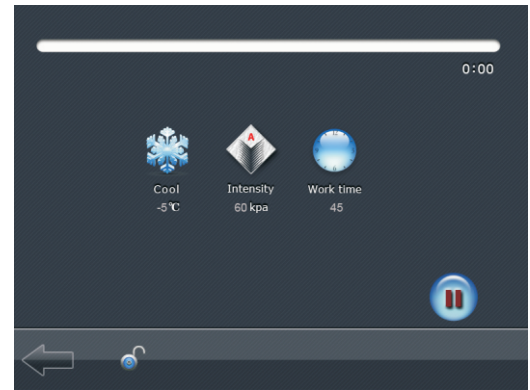

(Fig 5)

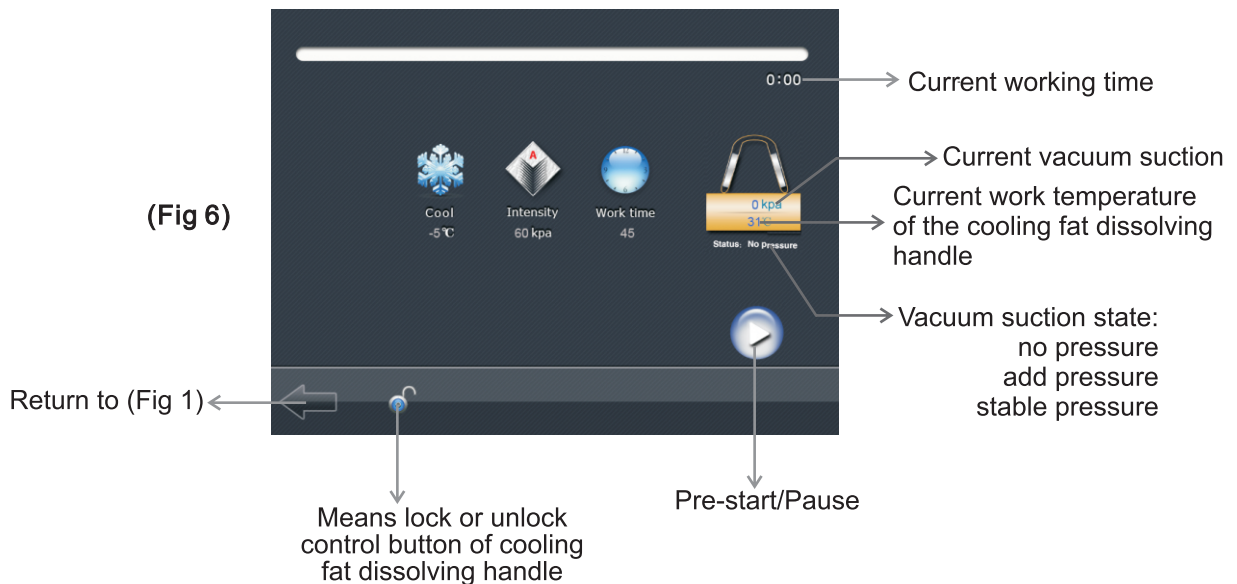

(Fig 6)

6. Press the control button of cooling fat dissolving handle[11], the system start working.  $\Delta$ the temperature come down freezing temperature that has been set. The green light when begin freezing fat dissolving.  
Green Light: Reducing the skin edema during the freezing treatment.
7. The system start working. At this time the setting work time can not be adjusted; cool treatment temperature and vacuum intensity can be adjusted.



## Treatment Setting

- 30-60 minutes for each part (depending on thickness of fat and health status).
- Take another cooling procedure at the same position 2 months after the first course, which can reduce the extra fat layer thickness, twice treatment, can enhance the effect of cryolipolysis.
- The freezing fat treatment designed for localized hypertrophic fat accumulation area, physical healthy people, but not suitable for overall obesity. Treatment mainly for a particular part, such as waist fat, belly and back, and other local cellulite. Treatment is not omnipotent and can not cure obesity, it can not replace liposuction or other invasive therapies. A Substantial weight loss should be through a balanced diet and do regular exercise, freezing fat treatment can only be carried out for extra fat.
- Proposed selecting conformable therapeutics according to the fat thickness.  
[practical according to clinical situation]

## Skin Antifreeze

Qualified antifreeze should be used during the treatment, that avoid frostbite when temperature lower to the 0 to -40 degree. [Consumables, purchase on your own]

## Operation Process

- Please checking whether the number of the coolant level window is above 4.5 before turn on the machine. If it less than 4.5, please add coolant to avoid the bad effect on the cooling system.
- After start, the system enter interface as (Fig 6).
- Ask them there is other disease inapplicable to the treatment.
- Check the thickness of the fat, with the help of fat calipers. The cool temperature refer to the fat thickness reference table.
- Clean treated area ,Clear the hair of the treated area.
- Mark the size of treatment area.
- Open the package of antifreeze membranes.
- First, take out the small antifreeze membrane and smear the edge and inside of cooling fat dissolving handle.
- Then open the big antifreeze membrane as (Fig8) shows.
- Paste antifreeze membrane on treatment area as (Fig9) shows.
- Patients receiving the waist and abdomen treatment should be sitting make upper body and thigh to 90 degrees as (Fig7) shows.
- Set cool temperature and work time according to thickness of fat.
- Click “||”, the machine is into the standby.
- Make the cooling fat dissolving handle to suck the treated area gently as (Fig 10) shows, press the control button once to start vacuum suction. (add pressure)
- When the suction strength is suitable, press the control button again, to keep the stable pressure. Click the “🔒” as (Fig 6), locking buttons of freezing fat dissolving handle. If change the work state, please click the “🔓” key to unlock it.
- Treatment course start timing... Use bind ties to fixed the cool fat dissolving handle as (Fig 11).

Thickness	Dose	Time
<input type="checkbox"/> <20mm	<input type="checkbox"/> 0 °C	<input type="checkbox"/> 60min
<input checked="" type="checkbox"/> 20-40mm	<input checked="" type="checkbox"/> -5 °C	<input checked="" type="checkbox"/> 45min
<input type="checkbox"/> 30-50mm	<input type="checkbox"/> -8 °C	<input type="checkbox"/> 40min
<input type="checkbox"/> 50-60mm	<input type="checkbox"/> -10 °C	<input type="checkbox"/> 40min
<input type="checkbox"/> >60mm	<input type="checkbox"/> -11 °C	<input type="checkbox"/> 40min

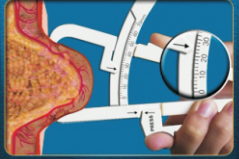

Fat thickness reference table



(Fig 7)



(Fig 8)

Antifreeze membrane



(Fig 9)

Paste membrane



(Fig 10)

Absorb



(Fig 11)

Treatment in progress

## After Treatment



Damage, minor frostbite, skin pigment may occur at the treated area, care properly.

## Caution



1. The machine must be operated by professionals.
2. Observe the status of coolant level window before operating everyday, the level can't less than 4.5.
3. Banned in no case of anti-freeze membrane treatment, during the course of treatment must ensure anti-freezing film completely cover the therapeutic part, otherwise can appear frostbite, etc.
4. According to the clinical, Individual physical users may occur frostbite reaction, you can raise the temperature according to fat thickness or consult professional person.
5. Cautions especially:

The person please do not treat a large area of body or treat the adjacent part of the body that have been treated in the same course of treatment. As (Fig12) shows: if you operate of part ①, you can not operate the part ② or part ④, so you can only operate part ③. If you against this regulation, Light will cause the metabolic disorders, Heavy then cause metabolic acidosis and the toxins from body doesn't stranded.

6. Patients using the following medical electrical equipment can not use the machine.

- Implanted cardiac pacemakers or other implanted electronic devices;
- Life-sustaining artificial heart-lung machines and other equipment;
- Portable ECG measurement equipment;

7. The following patients should be agreed by the professional doctors before using the equipment.

- Patients with acute disease;
- Malignancy;
- Patients with Infectious diseases;
- Pregnant women;
- Patients with heart diseases;
- Patients with fever;
- Patients are receiving treatment or those with abnormal body phenomenon;

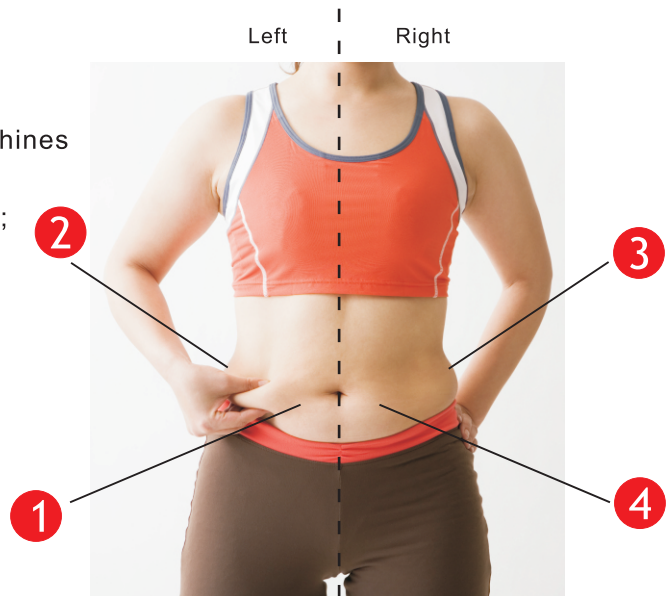

(Fig 12)

- ※8. If the screen display: “Please check and clean the filter cup!” or “Filter cup is full, please clean!”, Please check the filter and clean it immediately, then press any key to exit. Otherwise maybe damage the machine.

---

---

## Announcements on Clinical

Freezing fat machine can freeze fat ,at the same time, it may have the following risks:

- 1.Now research shows that individual who has skin without cold-resistance will have cold injury phenomenon when chose -5 degree or below. We suggest 5-0 degree for this kind of crowd.
- 2.For customers who use for the first time, they shouldn't choose below -8 °C. -8 °C to -10 °C is suitable for fat layer thickness reaching 55mm or more .Please don't use it if the fat is less than 55mm, or it will have risk of cold injury.
- 3.If the liquid in anti-freezing membrane is too little (Normal is opening the package, you can see there is little liquid in bag or the membrane is very moist),please do not use. Abundant liquid can well protect the skin from been frostbite.
- 4.Please check if the anti-freezing membrane can fully cover the treatment area. The skin will have cold injury in 2 minutes without the membrane.
- 5.For sucking in the skin at the beginning of the treatment, you can choose vacuum pressure(40-70kpa), after 3 minutes, please adjust pressure to 40kpa, long time in high pressure(60-80kpa) during the treatment will increase the risk of skin blisters.
- 6.Coldinjury phenomenon:

Check the therapeutic part and you may have cold injury if the skin becomes harder or has lump, please use warm towel (42 degree) to cover the skin for 10 minutes. The treatment part will have blebs, skin will scab after the bubble bursts, keep cold injury wound clean and dry, apply frostbite cream for a few days and the wound would heal.

Another processing Method of deal with bleb:

Because of frostbite, if you have bleb, mild only prevention of infection. Severe should aseptic puncture fluid, coated with Basic Violet 3 of 1% -2% is ok.

## Contraindications

- Liver problems;
- The Raynaud's disease;
- Severe cold urticaria;
- Cryoglobulinemia;
- Cold fiber hypoproteinemia;
- Severe frostbite;
- Severe diabetes and the elderly, young children, frail and so intolerant of cryotherapy;
- Patients with physiologiactal hypotonic.

---

---





## Technical Parameters

- 1.Input: 220V/50Hz  110V/60Hz
- 2.Power: 450VA
- 3.Heat: 37°C ~45°C
- 4.Cryo: 5°C to -15°C
- 5.Vacuum: 10~80Kpa
- 6.Light: Green (570nm) 50mWX4
- 7.Cooling liquid: Pure water or special coolant
- 8.Ambient temperature: 5°C ~40°C
- 9.Relative Humidity: ≤80%
- 10.Atmospheric pressure: 86KPa~106KPa

## Package List

1.Host	1pc
2.Cooling fat dissolving handle	1set
3.Fat calipers	1pcs
4.Accessories frame	2pc
5.Two pieces of liquid addition accessory	1set
6.Power supply line	1pcs
7.Band ties	1pcs
8.User manual	1copy
9.Black sealing ring	10pcs
10.M5 hexagonal screw driven	1pc
11.M6 hexagonal screw	6pcs

## Symbols and meaning

Warning Symbol	Meaning
 Danger	If used incorrectly will bring the risk of death or serious injury.
 Warning	If used incorrectly will cause the possibility ill of deaths or serious injury.
 Attention	If used incorrectly will cause personnel injury or damage to the goods.
 Danger	Device exists high pressure risk of high voltage output terminals
 Attention	If used incorrectly will cause personnel injury.

Things damage refers to housing, property, livestock and pet damage.

## Contraindications



1. The following symptoms were forbidden to use

- (1) Patients who used by Heart rate regulator, cardiac pacemaker, ECS (electro-cardioscanner);
- (2) The use of artificial bone;
- (3) Patients with silicosis;
- (4) Drunk or high fever patients;
- (5) Patients with higher sensitivity mental disease and epilepsy patients
- (6) Patients with no independent expression consciousness and can not take care of themselves.
- (7) Patients with metal materials in body (including metal teeth), pregnant women, cachexia, malignant tumor.
- (8) Severe hypertension and severe patients with cardiovascular and cerebrovascular disease.
- (9) Patients with renal failure.
- (10) Patients with severe infection



2. The following please use under the guidance of professionals

- (1) Women during menstruation;
- (2) Children;
- (3) Hemorrhagic disease or trauma, inflammation, skin disease, skin infection;
- (4) Patients with feeling numb, no response to cold and heat;
- (5) The immune system has defects, scar formation history, physical disease;
- (6) The people who has taken face-lifting or her body has artificial thing.



---

---

## Attention

1. First check the host, accessories, power supply line is broken or not before use.
2. Start the system, in addition to television, refrigerator, Do not open electrical power device at the same time.
3. Before use, please take the hearing aid, electronic wristwatch, magnetic card, mobile phone and other things off first. Pay attention to the child's care to avoid touching.
4. During the using process, drink more water based on your physical.
5. In case of happen special circumstances or accident, please immediately stop using and consult professionals.
6. Patients with following medical electrical device cannot use this system at the same time.
  - Patients who implantable cardiac pacemaker, heart rate regulator and other electronic devices.
  - Artificial heart lung device and other device to sustain life.
  - Patients with ECG scanner device .
  - Patients with metal materials in body (including metal teeth), using artificial bone.
7. The following user should be agreed by the professionals before using this device.
  - Patients with acute disease.
  - Patients with malignant tumor.
  - Patients with Infectious disease.
  - Pregnancy women.
  - Cardiac disease.
  - Patients with high fever.
  - Being treated or physical abnormalities.
8. Please immediately turn off the power supply and stop using if following abnormal situation happened.
  - (1) Water and other matter into the host.
  - (2) Host, power supply line, accessories line and plug etc. occur the abnormal heating, leakage.
  - (3) The sound to be unusual.
  - (4) Abnormal smell, smoke.
  - (5) Any accessories damaged.
  - (6) Natural disasters and earthquake, the sudden thunder
9. When the treatment is finished, please cut off the power supply, be sure to unplug the power plug from the power socket.
10. Please check the power supply line, accessories line carefully every time before use, if found damaged, you should stop using and replacing it.
11. Transportation and storage conditions:

Transport according to the requirements of the order contract, the transport process should be to prevent the sun and rain; packaged equipment should be stored in relative humidity of not more than 80%, no corrosive gas and ventilated room.
12. The warning mark produce in the specification, its purpose is to enable you to safely and correctly using this device, and to prevent you and others to injury.

## Maintenance

1. Appliances and medical equipment close to the machine may be resulting in operational failure due to Interference.
2. Prohibit use of the equipment in the following environment
  - Hot and humid environment
  - Dusty environment
  - Environmental with much smoke or steam
3. If there comes a failure, please shut down the power immediately, and send it to the distributor or manufacturer for maintenance. Do not repair by yourself.

### 4. Exclusion of liability.

The Company is not responsible for the following circumstances:

- (1) If fire, earthquake, war occurred;
- (2) The fault of the user, operator error;
- (3) Damage caused by using other method (not included in the use manual).
- (4) Operate without the manual's guide.

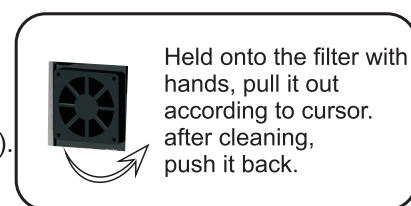

5. After using the machine for over 40 hours, please take off the dust filter and clean it (If have).
6. Do not make the machine close to the wall, keeping a 30CM space around for cooling.

## Safety and Environmental Considerations

### Hazardous Substances or Elements Contained in the Product

Part Name	Toxic and Hazardous Substance or Element						NOTE
	Lead (Pb)	Mercury (Hg)	Cadmium (Cd)	Hexavalent chromium (Cr(VI))	Polybrominated biphenyls (PBB)	Polybrominated diphenyl ethers (PBDE)	
Plastic parts	○	○	○	○	×	×	
Metal structures / decorations	×	○	○	○	○	○	
Printed Circuit Assembly	×	○	○	○	○	○	
Power Line	×	○	○	○	○	○	
Power cord	×	○	○	○	○	○	
Relay	○	○	×	○	○	○	
Buzzer	×	○	○	○	○	○	

- × Toxic and hazardous substance in at least one homogeneous materials of the part exceeds the concentration limit requirement described in SJ/T11363-2006.
- Toxic and hazardous substance in all the homogeneous materials of the part is either below the concentration limit requirement described in SJ/T11363-2006 or is not applicable because the part is not used.
- Products to be discarded after use, Please treat in accordance with electronic and information products recovery, re-use legal regulations.

#### Technical note:

Hardware structure of the machine parts, injection molded parts, and the majority of electronic components, connectors meet the requirements of the EU and China RoHS directives.

Only a few parts as the global technology limitations that may affect product reliability, and not find a substitute for the toxic and hazardous substances, please be assured to use, use under normal conditions will not cause health effects on users.

---

---

## Simple Troubleshooting

When the instrument appears fault during the operation, the user could diagnose and rule out some simple questions through the following guides. If still not resolved, please call our Customer Service Department for consulting as soon as possible.

1.Nothing happens when turning on the general power switch.

- (1)Ensure that the AC power is normal or not.
- (2)Ensure that the power supply line is broken or not.
- (3)Ensure that the fuse is normal or not.

2.The touch screen failure.

(1)Touch screen click on invalid:

May be the touch screen is pressed, please gently press the four corners and the center of the screen, then turn off the instrument , wait for one minute ,then restarts it.

(2)Positioning error of touch screen:

Turn on the instrument, enter interface of calibration. If the problem still exists, please call the Customer Service Department.

(3)If the touch screen is broken, please call the Customer Service Department.

3.Touch screen display error:

Please turn the power off, wait one minute after a reboot, If the problem still exists, please call the Customer Service Department.

4.After starting, the screen displayed:

E0:Connection failure between display control board and handles control board.

Please check wether the plug of cooling fat dissolving handle [8] connect well or not, and then reboot.

E1:Connection failure between display control board and function control board.

May caused by the loose connection between display control board and function control board.please call the Customer Service Department and operating under their guidance.

E2:Flow sensor fault! To add water or not!

(1)Check wether the connection of the equipment to handle is being pressed or folded please.

(2 If the problem still exists, Please read the add coolant steps and cautions ,add the coolant again.

E4/E5:The temperature sensor of left/right working head is out of work, please get away from the working head to avoid burning.

(1)If the temperature deviation of the work piece in left / right handle is too large, that may cause alarm. At this moment, Please back the handle and judge the work piece is work after no-load for 30 minutes and observing the left / right work piece freezing.

(2)Temperature rises after power on may cause the alarm:

①Start cooling, heat the work piece and then the temperature slowly increased, if causing alarm, please check the coolant ,if abnormal coolant, re-join the coolant.

②1 to 2 minutes after power on, the abnormal temperature rise without refrigeration process. If causing alarm, please replace the handle for the broken handle.



## Filter cup Remove&Install Method

### Filter cup structure

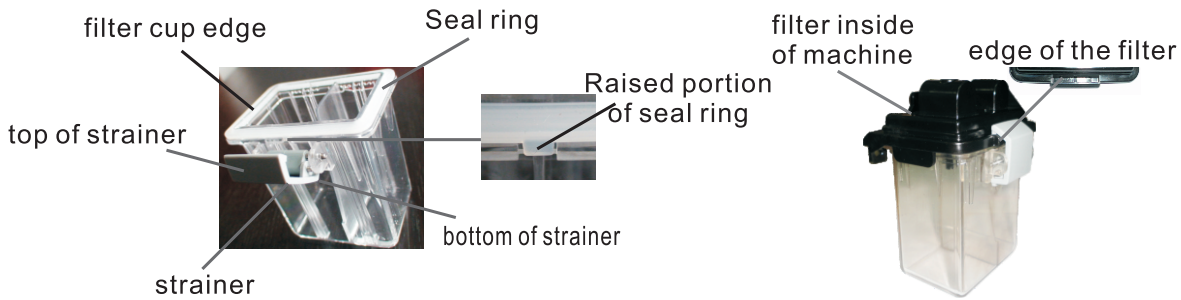

### Removing the filter cup operation:

1. Your fingers against the strainer bottom, as (Fig 1) shows.
2. Pull the bottom of strainer, as (Fig 2) shows.
3. And then hike up the strainer, be sure it fully opened, as (Fig 3) shows, take off the filter.



( Fig1 )



( Fig2 )



( Fig3 )

### Install filter cup operation:

1. The filter cup slanting inside the host frame, be sure the filter cup edge connect well with filter. as (Fig 4) shows.
2. lift the filter cup to close the filter. as (Fig 5) shows.
3. Make the strainer hold the edge of the filter and press the lower side of the strainer inward. as (Fig 6) shows.
4. Installation finished, check whether connect the filter cup and filter well. as (Fig 7) shows.



( Fig4 )



( Fig5 )



( Fig6 )

### Replace the seal ring method:

1. Put the seal ring in without raised portion in the slot of the filter cup edge. as (Fig 8) shows.
2. Aim the raised portion at the nick up towards filter cup strainer, put seal ring well along the filter cup edge. as (Fig 9) shows.

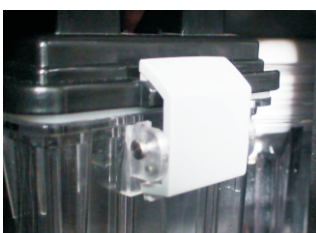

( Fig7 )

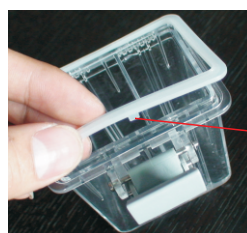

( Fig8 )

Raised portion of seal ring

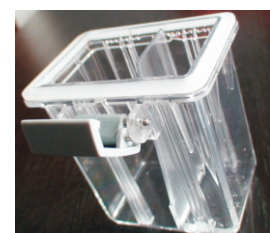

( Fig9 )

# Treatment table

Name		Sex		Age		NO:
Height		Weight		Heart rate		

Ask before treatment:

- |   |            |           |
|---|------------|-----------|
| 1. Have liver disease or not?                             | Yes [    ] | No [    ] |
| 2. Have Raynaud's disease or not?                         | Yes [    ] | No [    ] |
| 3. Have severe diabetes or not?                           | Yes [    ] | No [    ] |
| 4. Have cold hyperfibrinogenemia or not?                  | Yes [    ] | No [    ] |
| 5. Have cryoglobulinemia or not?                          | Yes [    ] | No [    ] |
| 6. Have serious cold urticaria or not?                    | Yes [    ] | No [    ] |
| 7. Have surgery during the year or not?                   | Yes [    ] | No [    ] |
| 8. Have done more than 2 parts of cryotherapy in a month? | Yes [    ] | No [    ] |

**If any answer is yes, please do not accept this therapy.**  
**Individual physical users may occur frostbite reaction, if not accept, please do not accept this therapy.**

**Customer Signature:**  
**Date:**

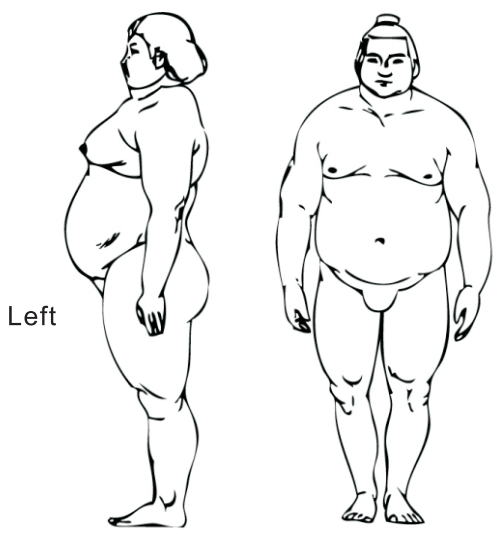
 <p style="text-align: center;">Mark the treatment area and assign a number</p>	<p><b>Part 1</b></p> <p>Treatment start date:        D    M    Y          Treatment time:                min          Temperature:                    °C          -----</p> <p>Countercheck 2 months after treatment:          Good effect [    ]    Ordinary [    ]          The second course start date:        D    M    Y          Treatment time:                min          Temperature:                    °C          -----</p> <p>Countercheck 3-6 months after treatment:          Good effect [    ]    Ordinary [    ]</p> <p style="text-align: center;">Please take photos before and after treatment</p>
---	---

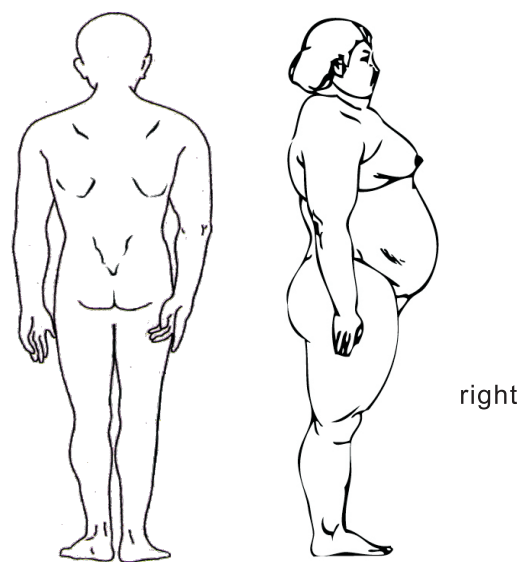
 <p style="text-align: center;">Mark the treatment area and assign a number</p>	<p><b>Part 2</b></p> <p>Treatment start date:        D    M    Y          Treatment time:                min          Temperature:                    °C          -----</p> <p>Countercheck 2 months after treatment:          Good effect [    ]    Ordinary [    ]          The second course start date:        D    M    Y          Treatment time:                min          Temperature:                    °C          -----</p> <p>Countercheck 3-6 months after treatment:          Good effect [    ]    Ordinary [    ]</p> <p style="text-align: center;">Please take photos before and after treatment</p>
--	---